

9 3
Trailer City NEWS

Issue 6

PLANT PERSONNEL PRAISED BY NRC OFFICIAL

An interesting part of the NRC press briefing yesterday has received scant attention from the media.

William Kreyer, a member of Harold Condon's staff, has been in the IMI 2 control room from the 8 p.m. to 8 a.m. shift since last Friday.

He reported in Thursday's NRC press briefing that the plant activity has been "very orderly" and "very professional."

Mr. Kreyer said that "We've observed from the very beginning a very calm, very professional attitude on the part of the staff (Met-Ed) which consists of the shift supervisor, the senior operators, auxiliary operators, and for the first several days, the health physics staff operating out of the control room. These people, in viewing that scene, there's no evidence that there's anything but a very orderly, very professional operation going on."

Mr. Kreyer added: "My reaction from seeing the activity from Friday afternoon on was that the situation must have been well under control even during the early hours, as far as activities of the staff."

That's the opinion of an NRC official from personal observation.

CATALYTIC SWITCHBOARD

Guys, we goofed yesterday and gave the wrong number for the catalytic switchboard. It's 944-7621 the switchboard is open from 7:30 a.m. to Midnight. Remember, don't call the Island unless it is a must. If you must get into the Island after midnight, it can be accomplished through the Met-Ed switchboard--944-4041.

EXPENSE REIMBURSEMENT

IMUSC, Met-Ed, JCPM, Peoples employees and consultants to Met-Ed should contact Charlie O'Neill for reimbursement of expenses. Charlie is in Trailer 13.

AIRLINE RESERVATIONS

Anyone needing assistance in securing airline reservations, please contact Debbie Noble at the Reading office--717-921-6163.

IMI PERSONNEL READ THIS

Met-Ed time slips from the Island must be in the Observation Center daily by 7 a.m. in order to process the proper payroll forms.

TELEPHONE DIRECTORY CHANGES

If you have a change for the telephone directory, please call the PBX operator on Ext. 37, only.

If there is something wrong with your extension, dial "0" and tell the operator about it.

140 359

DIRECT OUTSIDE LINES

We're trying to cut down on the great number of direct outside lines. The present FAX system can handle some 100 simultaneous calls. So, let's give up the direct outside telephone if you don't absolutely need it and use a telephone extension.

OUT-OF-STATE INCOME TAX FILING EXTENSION FORMS

If you need out-of-state Federal income tax filing extension forms, contact Charlie O'Neill in Trailer 13. You should be aware that a filing extension can be obtained for your Federal income tax BUT you are still obligated (under penalty) to pay 90 percent of your tax due by April 16.

BLUE VAN SHUTTLE

There will be continuous shuttle service from 6 a.m. to Midnight with stops at the parking lot behind the Crawford Station, Trailer City in front of Trailer #1, and the front gate of the 500KV Substation.

Call the Communications Trailer 944-0129 for 24-hour service to motels.

NEW PARKING ARRANGEMENT

To alleviate the congestion in the Trailer City Parking Lot and to cooperate with the State Police in eliminating the congested parking along Rte. 441, new parking regulations will be implemented today.

All Trailer City personnel with security badges are to park in the 500 KV Substation. You must show your green or yellow I.D. badge when entering the parking area. Shuttle buses and vans will transport you to Trailer City (unless you prefer to walk). Those issued parking passes to the Trailer City lot are also asked to assist by parking at the 500 KV Substation.

Anyone working on the Island, can drive across the South Bridge and park in the West parking lot below the time office gate.

With everyone's cooperation, the new plan will work. More importantly, we will avoid the necessity of the State Police ticketing and/or towing away cars parked on Rte 441.

MAIL ROOM IS IN TRAILER #1

All mail for inside and outside delivery must be brought to Trailer #1 where a new mail room has been set up. Off-site mail will leave the mail room at 10:30 a.m. and 5 p.m. Special delivery of mail from Trailer City to the TMI mail room will leave the mail room in Trailer #1 at about 2p.m. daily. Please use name and trailer number on all internal communications.

TRAILER CITY

DD FORM 100-1037
REV 4-5-79
3125

HELIPORT

TOILET FACILITIES

KITCHEN/FOOD TENTS

TRINSE

ONE WAY

PARKING LOT

ONE WAY

BULL

RAD. MON.

128

124

WHEEL

OBSERVATION CENTER

SECURITY

DEWEY HOUSE

GAR.

PAY PHONE

NEWS

CBS
NBC
ABC

140 361

RTE. 411

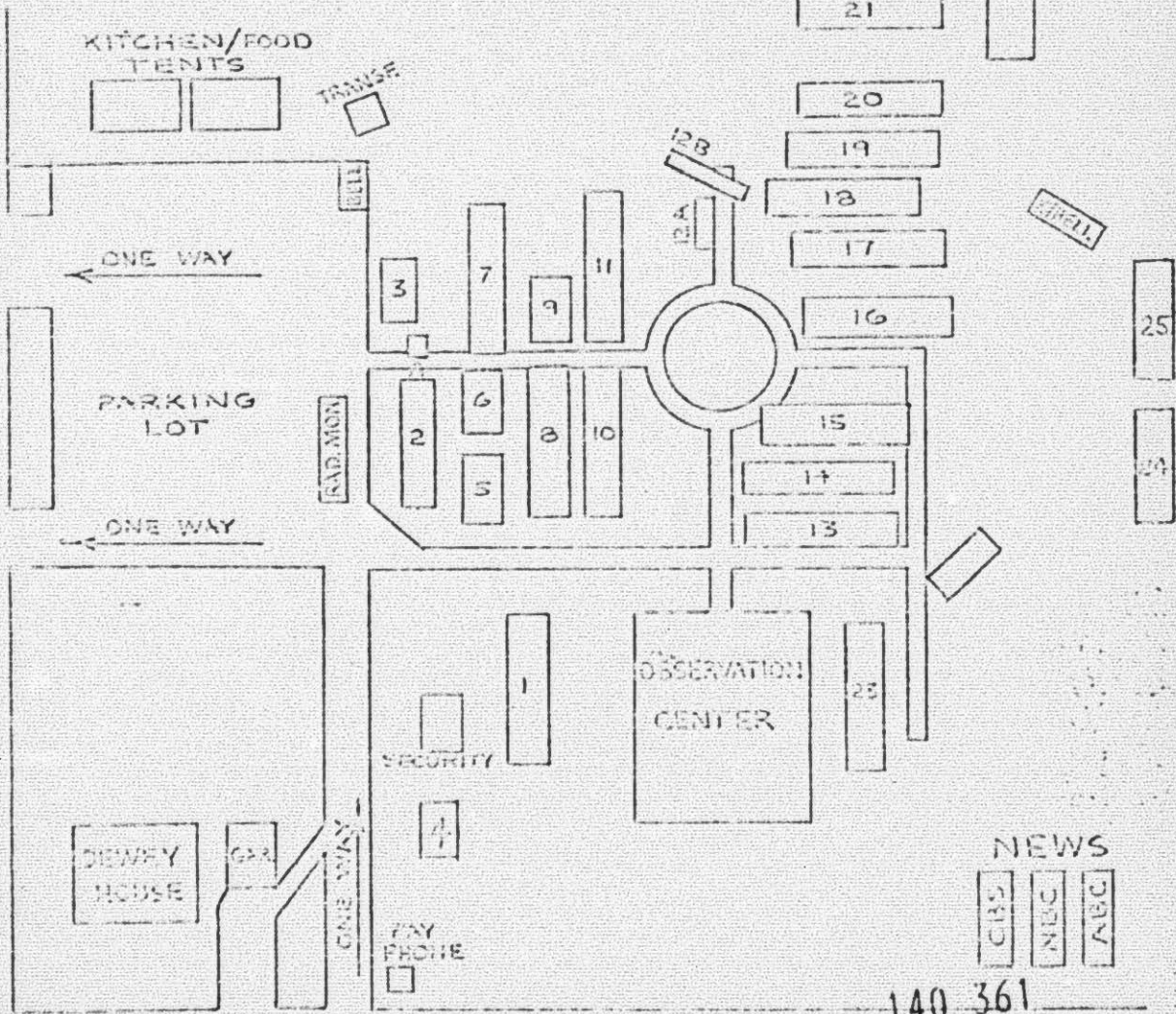

Station	Function	Personnel	Outside Numbers	
Security	Security/ID Tags	Dzanski, Stacey	944-1458 "EMERGENCY EMPLOYEE MESSAGES"	Ext. 111
14 Met-Ed	Communications Transportation Mail Room	Fabrizio/Carrin Seelig/Henry	944-0303	112, 13, 14
2 Police	Communications	Mason	944-4067, 68, 69, 4060	
2 Met-Ed	PBX Telephones	31 Hr. Telephone Ops	233-9045	0 & 137
1-SEC	Communications			
3-SEC	Instrument Van			
3-SEC	Mobile Lab			
7-SEC	Administration			
8-SEC	Support			
2 Met-Ed	P.L. & Meteorology		944-7730	
	Montgomery			
2 Met-Ed	ULD, R.P., Logistics/Key Punch		944-9592, 7004, 0805	115, 16, 17
1-OPU	Adm. Support/ Logistics Support		944-6727, 5070, 367-6266 944-1266, 1505, 367-4887	
2A Met-Ed	RSC Corp	Rad Seep Anal		118
2B Met-Ed	SAI	Rad Seep Anal		119
3 Met-Ed	Administration Clerical/Sec. Adm. Support	Craitz, Robidoux Quillen, C. Ulrich, O'Neill	944-9793, 367-4116 367-4030, 7901 367-4030	121 120 156
4 GPU	ADMINISTRATION	Dieckamp/Williams Fischer/Leng	944-4411, 4620, 4057 4075, 4610, 4624, 4023	122, 123 123, 124
5 Met-Ed	Data 160 Computer Telecommunications	Herman/Lessig/Towers Light/Barry/Hood	367-6358 367-0318	126 125
6 Met-Ed	TMI-Maint./Payroll Catalytic	Shovlin	367-0358 367-5528	127, 128 129
7 Met-Ed	TLB Burns & Roe-"Plant Motif"	Cobean	367-5212, 4151	159
3 SEC	Environmental			
1 Met-Ed	Outside Support	Technical	944-4631, 4643	
0 Met-Ed	Trailer Support Waste Management	Parker	367-6919	
1 GPU/Met-Ed	TMI:Adminis.	Herbain/Miller Manning, Colitz Scheduling Tools		134 132, 133 130, 131
2 Met-Ed/ GPU	Staff Meeting Trailer	Schedule By El	944-4646, 4649	
3 Met-Ed/ GPU	Task Management/ Construction Eng.	Arnold Stern	367-6451 367-1135	142 141
4 Met-Ed	End Cap/R.P.	Grayson/Murri	367-5219, 6218	139, 140
5 Met-Ed	Trailer Const. & Maint.	Strand/Ragner		150
	Task Mgt./Drafting	Edelson		151
Met-Ed	Personnel Eval.	Reich/Mulvey	944-5812, 6324 367-0561, 0518, 4644/0/19 367-0561, 6618, 4644, 0/19	145, 146, 147, 1
Met-Ed	Expense	Computer	367-0216	149

Eng./Construction/Conditions/Personnel, etc. to this - contact Rick Ulrich Ext. 153
residing: Trailers, House, Obs. Center, Williamson, Bldg. 26, Tel. Oper's of GPU & Subsidiari

141 001